



LIFTING CLAMPS & MAGNETS

IPSC10

Suitable for use in positioning & turning steel plates and sections. Not to be used as a lifting clamp.



- Available in capacities of 1.5 and 3 metric tons (higher Working Load Limits are available upon request).
- Jaw openings available: 0 to 60mm.
- Suitable for steel with a surface hardness up to 300 HV10.
- Forged alloy steel body for strength and smaller size. Forged alloy components, where required.
- Individually Proof Tested to 2 times the Working Load Limit with certification.
- Company name (Crosby IP), logo, Working Load Limit and jaw opening permanently stamped on body.
- Each product is individually serialized, with the serial number and Proof Load test date stamped on body. User manual with test certificate is included with each clamp.
- Maintenance and repair kits are available.

Model IPSC10

Load Rated

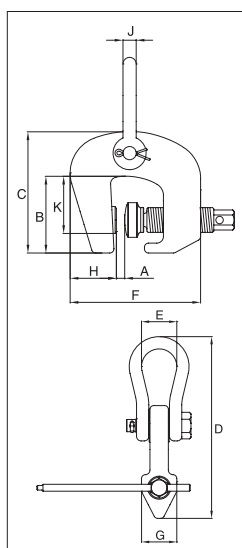

Model	Working Load Limit (t)*	Stock No.	Weight Each (kg)	Dimensions (mm)									
				Jaw A	B	C	D	E	F	G	H	J	K
IPSC10	1.5	2703857	4.6	0 - 40	91	143	251	44	156	50	45	16	65
IPSC10	3	2703858	8.4	0 - 60	109	175	310	51	200	62	55	19	83

* Design Factor based on EN 13155 and ASME B30.20.

